

UMD Model 264 Series Custom Keyboard

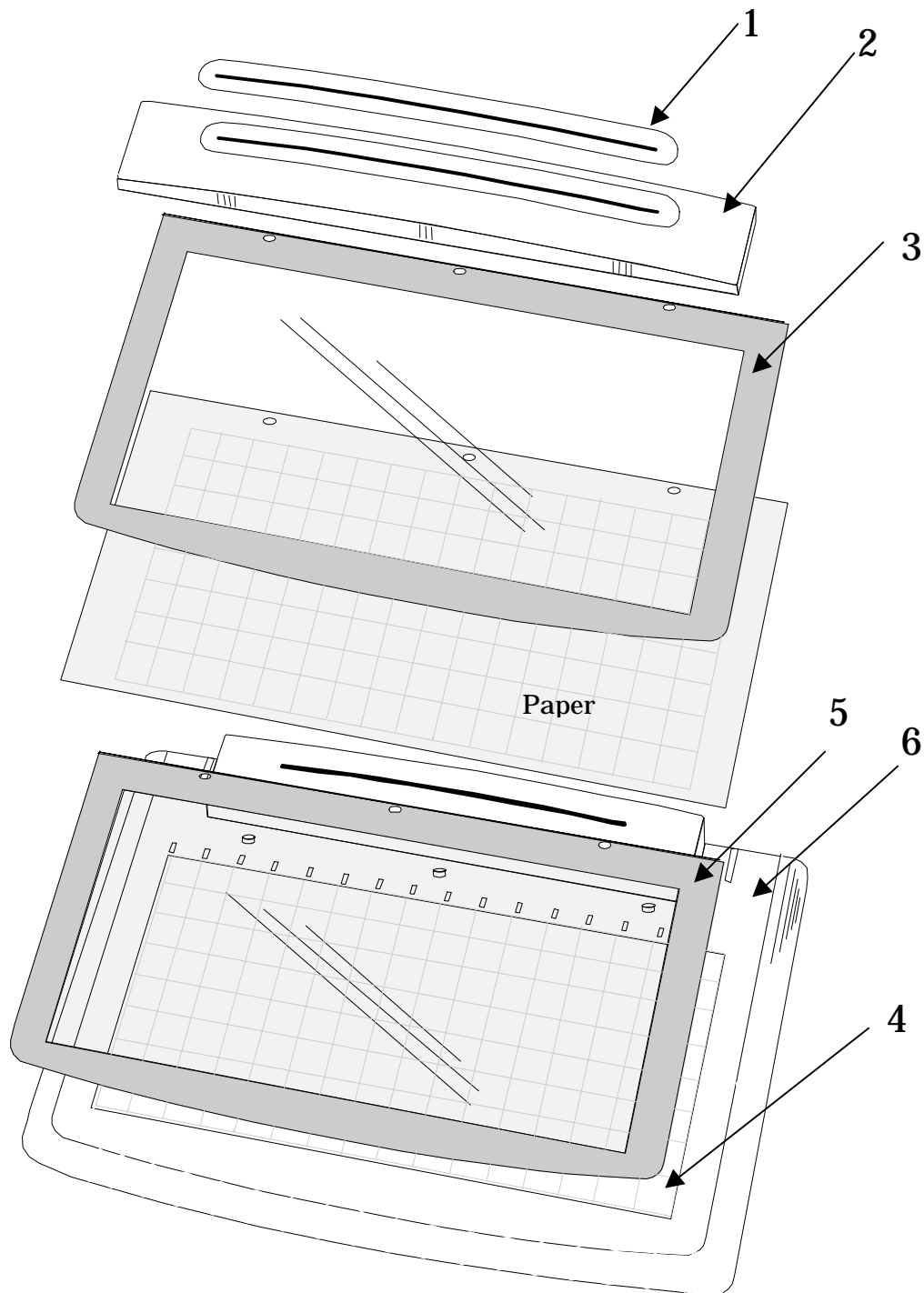

Spare Parts Manual

A. Drawings



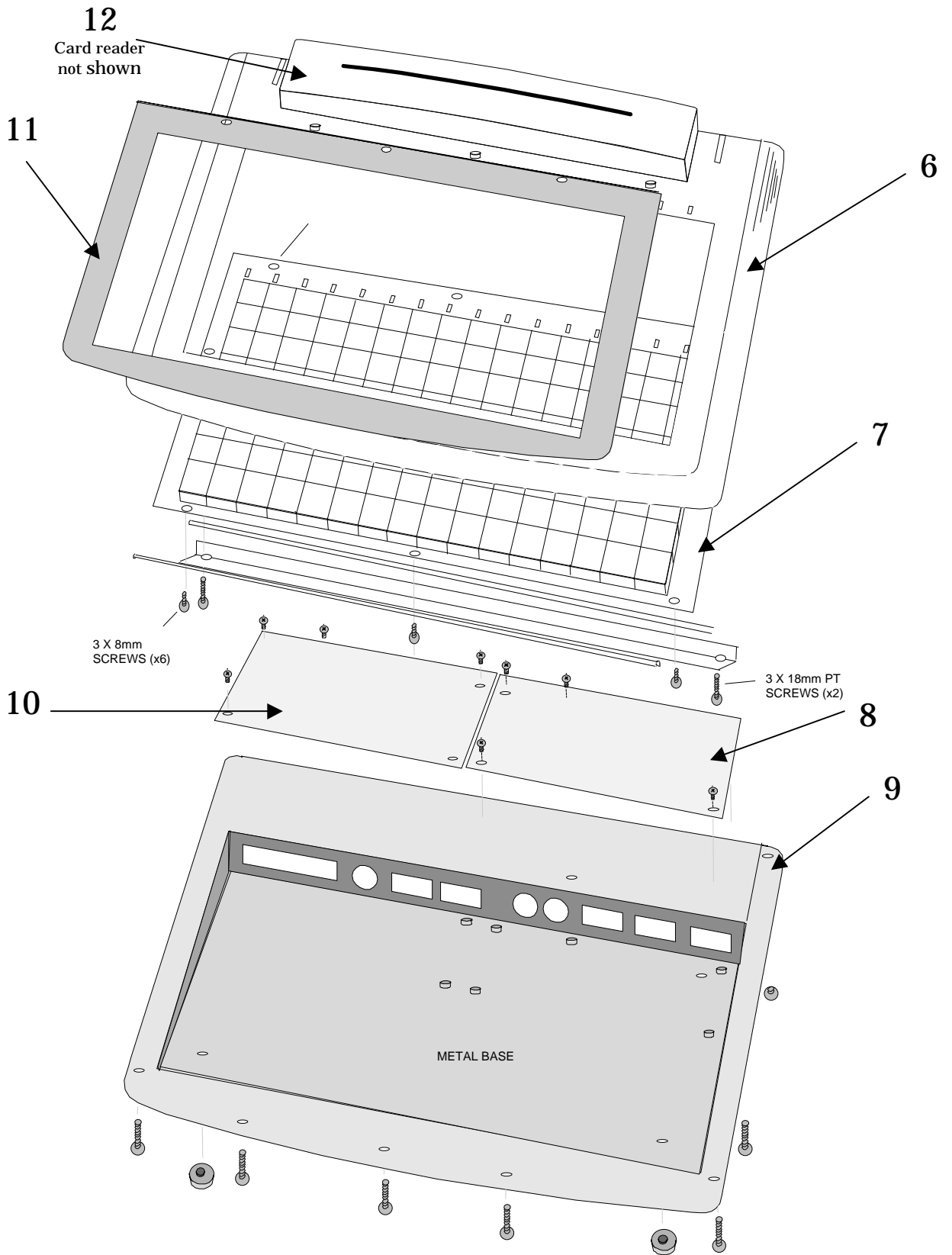

B. Spare Parts List

Item	Part Number	Description
1	4-0021-400-1	Escutcheon UMD STD Grey
1	4-0021-401-9	Escutcheon Blank STM Grey
1	4-0021-403-8	Escutcheon Blank STM Beige
2	4-0020-200-4	Top Cover Plastic Flip Lid ABS Grey
2	4-0020-210-3	Top Cover Plastic Flip Lid ABS Beige
3	4-0021-006-5	Overlay Blank STD
3	4-0021-010-8	Overlay Membrane STD Beige
4	3-1050-100-1	Keypad Membrane Full STD S00
4	3-1055-100-6	Keypad Membrane Full with L.C.D. S00
4	3-1055-200-2	Keypad Membrane QWERTY with L.C.D. S01
4	3-1050-100-1-EX	Keypad Membrane Full STD S00 Rebuild Exchange
5	4-0021-001-5	Sealing Film Blank STD Grey
6	4-0020-100-8	Housing Plastic ABS Grey
6	4-0020-110-6	Housing Plastic ABS Beige
7	3-1052-100-1	Keypad Key cap Full STD K00
7	3-1052-200-7	Keypad Key cap QWERTY STD K01
7	3-1053-100-6	Keypad Key cap Full with L.C.D. K00
7	3-1053-200-2	Keypad Key cap QWERTY with L.C.D. K01
7	3-1056-100-0	Keypad Key cap 24 Pump with 26 LED K10
8	3-1030-100-3	M301 Non EMC Fully Optioned
8	3-1031-100-1	M301 EMC Fully Optioned
8	3-1031-100-3-EX	M301 Non EMC Fully Optioned Rebuild Exchange
9	4-0020-301-8	Base Metal STD
9	4-0020-303-2	Base Metal Large Buzzer Hole
9	4-0020-304-9	Filler Plate Metal STD
10	3-1160-100-8	Video Controller VGA
10	3-1040-100-7	I/O Expander Fully Optioned S3, S4, CD, Parallel
11	4-0021-008-1	Surround Key cap STD Grey
12	1-8010-204-5	M.C.R. Track 2
12	1-8010-205-3	M.C.R. Track 2&3